

# Groovers

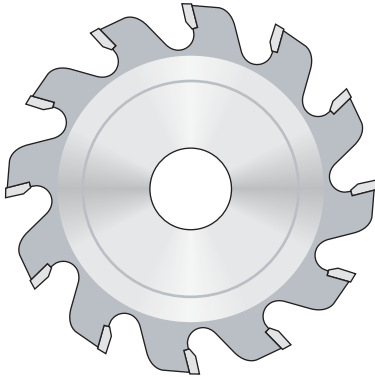

[ RIP STYLE SERIES ]

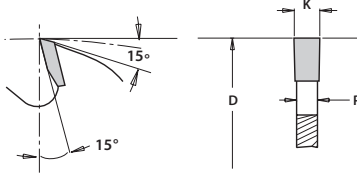

[ CROSS GRAIN SERIES ]

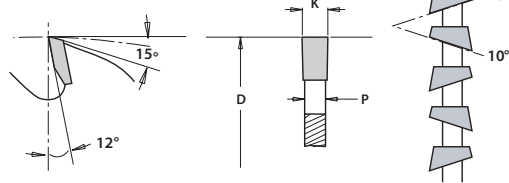

**Application:** Use groovers for cutting grooves in solid wood, plywood, veneered and plastic laminated panels. Use for standard table saws, sliding table saws, single or double end tenoners and CNC routers.

Carbide-tipped | Flat Top Design

**STANDARD SIZES**

Catalog #	Dia.	Teeth	Bore	Kerf	Plate
RG06125862	6"	12	5/8"	1/16"	TR/.040"
RG06125832	6"	12	5/8"	3/32"	.087"/.065"
RG06125818	6"	12	5/8"	1/8"	.087"
RG06125836	6"	12	5/8"	3/16"	.134"
RG06125814	6"	12	5/8"	1/4"	.187"
RG06125856	6"	12	5/8"	5/16"	.187"
RG06125838	6"	12	5/8"	3/8"	.250"
RG07185832	7"	18	5/8"	3/32"	.087"/.065"
RG07185836	7"	18	5/8"	3/16"	.134"
RG07185814	7"	18	5/8"	1/4"	.187"
RG07185856	7"	18	5/8"	5/16"	.187"
RG07185838	7"	18	5/8"	3/8"	.250"
CG08245836	8"	24	5/8"	3/16"	.134"
CG08245814	8"	24	5/8"	1/4"	.187"
CG08245856	8"	24	5/8"	5/16"	.187"
CG08245838	8"	24	5/8"	3/8"	.250"
CG10245836	10"	24	5/8"	3/16"	.134"
CG10245814	10"	24	5/8"	1/4"	.187"
CG10245856	10"	24	5/8"	5/16"	.187"
CG10245838	10"	24	5/8"	3/8"	.250"

**METRIC SIZES**

\* All metric sizes are in millimeters.

Catalog #	Dia.	Teeth	Bore	Kerf	Plate
RG100242032	100	24	20	3.2	2.2
RG150123018	150	12	30	1.8	TR/1.0
RG150123025	150	12	30	2.5	TR/1.6
RG150123035	150	12	30	3.5	2.4
RG150123050	150	12	30	5.0	3.7
RG150123060	150	12	30	6.0	4.8
RG150123070	150	12	30	7.0	4.8
RG150123080	150	12	30	8.0	4.8
RG180183025	180	18	30	2.5	TR/.6
RG180183050	180	18	30	5.0	3.7
RG180183060	180	18	30	6.0	4.8
RG180183070	180	18	30	7.0	4.8
RG180183080	180	18	30	8.0	4.8
CG200243050	200	24	30	5.0	3.7
CG200243060	200	24	30	6.0	4.8
CG200243070	200	24	30	7.0	4.8
CG200243080	200	24	30	8.0	4.8
CG250243050	250	24	30	5.0	3.7
CG250243060	250	24	30	6.0	4.8
CG250243070	250	24	30	7.0	4.8
CG250243080	250	24	30	8.0	4.8
CG250243010	250	24	30	10.0	6.35

\* TR= Thin Rim  
( Additional sizes are available upon request. )